

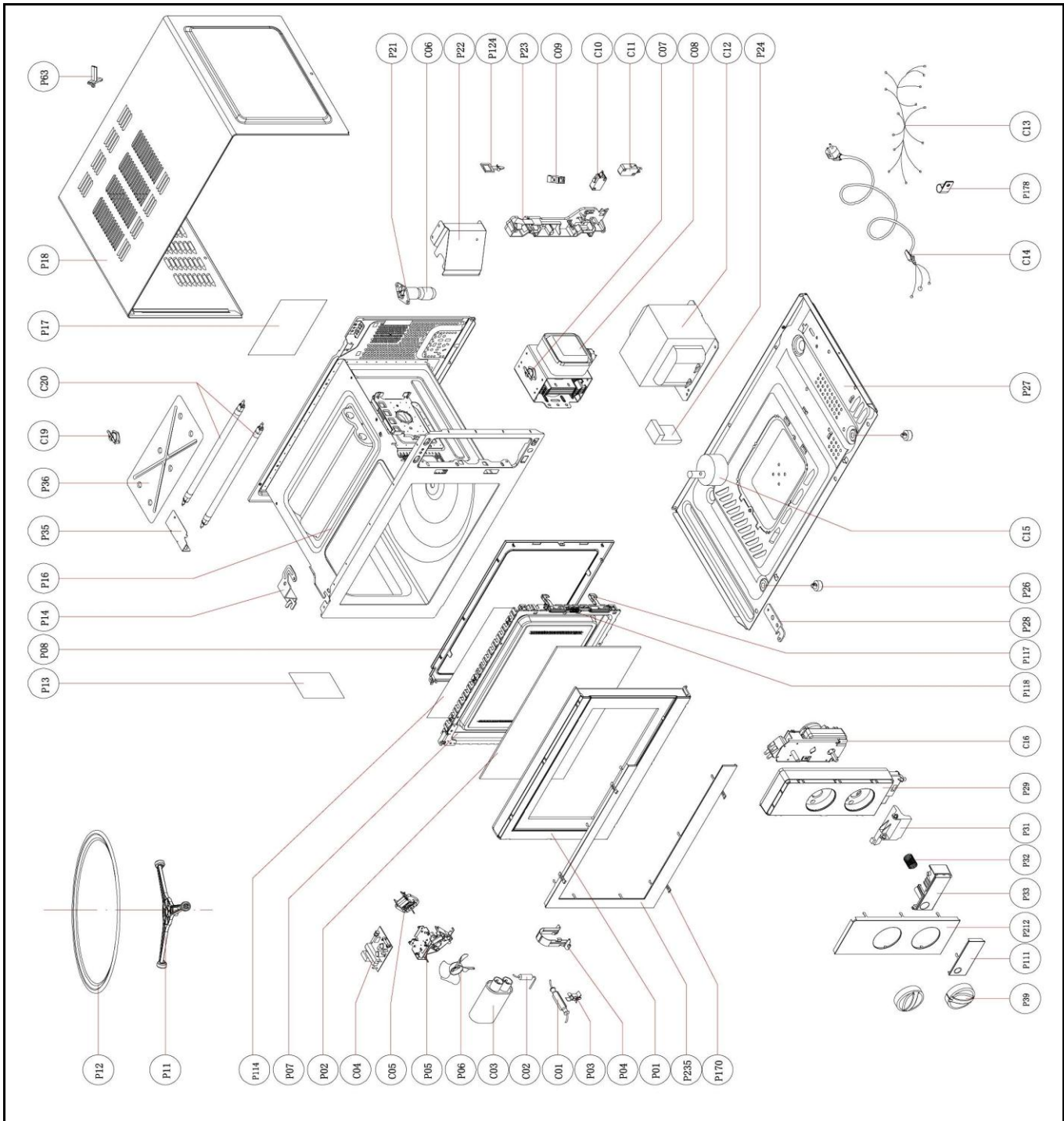

# Drawing

|   |                    |                        |
|---|--------------------|------------------------|
|  <p><b>Hendi B.V.</b><br/>                 Steenoven 21<br/>                 3911 TX Rhenen<br/>                 The Netherlands</p> | <b>Batch #</b>     | <b>Appliance part#</b> |
|   | 0000000            | 281703                 |
|   | <b>Description</b> |                        |
|   | Microwave          |                        |

|                 |                               |                   |                  |
|-----------------|-------------------------------|-------------------|------------------|
| <b>Date</b>     | 26-04-2012                    | <b>Revision #</b> | Revision version |
| <b>Revision</b> | First bill of materials (BOM) |                   |                  |



### Bill of materials (BOM)

|   |                    |                        |
|---|--------------------|------------------------|
| <br><b>Hendi B.V.</b><br>Steenoven 21<br>3911 TX Rhenen<br>The Netherlands | <b>Batch #</b>     | <b>Appliance part#</b> |
|   | 0000000            | 281703                 |
|   | <b>Description</b> |                        |
|   | Microwave          |                        |

|                 |                               |                   |                  |
|-----------------|-------------------------------|-------------------|------------------|
| <b>Date</b>     | 26-04-2012                    | <b>Revision #</b> | Revision version |
| <b>Revision</b> | First bill of materials (BOM) |                   |                  |

| Item | Description          | Part#  | Quantity | Remark                   | Picture |
|------|----------------------|--------|----------|--------------------------|---------|
| P01  | Door complete.       | 921449 | 1        |                          |         |
| P02  | Door window          | nss    | 1        | Available in set 921449  |         |
| P03  | Fuse socket          | n/a    | 1        |                          |         |
| P04  | Capacitor holder     | n/a    | 1        |                          |         |
| P05  | Fan bracket          | n/a    | 1        |                          |         |
| P06  | Fan blade            | n/a    | 1        |                          |         |
| P07  | Door frame           | nss    | 1        | Available in set 921449  |         |
| P08  | Cover door           | nss    | 1        | Available in set 921449  |         |
| P11  | Roller ring          | 921302 | 1        |                          |         |
| P12  | Glass tray           | 921319 | 1        |                          |         |
| P13  | Mica plate           | 928387 | 1        |                          |         |
| P14  | Upper hinge          | n/a    | 1        |                          |         |
| P16  | Housing              | n/a    | 1        |                          |         |
| P17  | Label                | n/a    | 1        |                          |         |
| P18  | Outer cover          | n/a    | 1        |                          |         |
| P21  | Lamp socket          | 904961 | 1        |                          |         |
| P22  | Air duct bracket     | n/a    | 1        |                          |         |
| P23  | Microswitch mounting | 921432 | 1        | (Set incl. C9,C10,C11)   |         |
| P24  | Rubber block         | n/a    | 1        |                          |         |
| P26  | Foot                 | 900390 | 4        |                          |         |
| P27  | Bottom plate         | n/a    | 1        |                          |         |
| P28  | Lower hinge          | n/a    | 1        |                          |         |
| P29  | Dashboard frame      | n/a    | 1        |                          |         |
| P31  | Lever                | 921326 | 1        |                          |         |
| P32  | Button spring        | nss    | 1        | Available in set 921326  |         |
| P33  | Button               | n/a    | 1        |                          |         |
| P35  | Tube holder          | n/a    | 1        |                          |         |
| P36  | Heat shield          | n/a    | 1        |                          |         |
| P39  | Knob                 | 921333 | 2        |                          |         |
| P41  | Metal rack           | 921463 | 1        |                          |         |
| P63  | Buckle               | n/a    | 1        |                          |         |
| P111 | Button cover         | n/a    | 1        |                          |         |
| P114 | Sheet                | nss    | 1        | Available in set 921449  |         |
| P117 | Door hook            | 921340 | 1        | Also available in 921499 |         |
| P118 | Spring door hook     | 900512 | 1        | Available in set 921449  |         |
| P124 | Clamp                | n/a    | 1        |                          |         |
| P170 | Clip (glass)         | nss    | 1        | Available in set 921449  |         |
| P178 | Clip                 | n/a    | 1        |                          |         |
| P212 | Dashboard cover      | n/a    | 1        |                          |         |
| P235 | Door cover           | nss    | 1        | Available in set 921449  |         |
| C01  | H.V.fuse (5KV-0,7A)  | 921470 | 1        |                          |         |
| C02  | H.V. diode           | 921357 | 1        |                          |         |
| C03  | H.V. capacitor       | 921364 | 1        |                          |         |
| C04  | Filter print         | 921371 | 1        |                          |         |
| C05  | Fan motor            | 900444 | 1        |                          |         |
| C06  | Lamp                 | 900468 | 1        |                          |         |
| C07  | Thermostat           | n/a    | 1        |                          |         |
| C08  | Magnetron            | 921388 | 1        |                          |         |
| C09  | Microswitch          | nss    | 1        | Available in set 921432  |         |
| C10  | Microswitch          | nss    | 1        | Available in set 921432  |         |
| C11  | Microswitch          | nss    | 1        | Available in set 921432  |         |
| C12  | Transformer          | 921395 | 1        |                          |         |
| C13  | Wiring harness       | n/a    | 1        |                          |         |
| C14  | Power cord           | 921456 | 1        |                          |         |

|     |                 |        |   |  |  |
|-----|-----------------|--------|---|--|--|
| C15 | Turntable motor | 921401 | 1 |  |  |
| C16 | Timer           | 921418 | 1 |  |  |
| C19 | Thermostat      | n/a    | 1 |  |  |
| C20 | Quartz tube     | 921425 | 2 |  |  |
|     |                 |        |   |  |  |
|     |                 |        |   |  |  |
|     |                 |        |   |  |  |
|     |                 |        |   |  |  |

n/a -> not available

nss -> not sold separately

### Circuit diagram

|  |             |                 |
|--|-------------|-----------------|
|  <p><b>Hendi B.V.</b><br/>Steenoven 21<br/>3911 TX Rhenen<br/>The Netherlands</p> | Batch #     | Appliance part# |
|  | 0000000     | 281703          |
|  | Description |                 |
|  | Microwave   |                 |

|          |                               |            |                  |
|----------|-------------------------------|------------|------------------|
| Date     | 26-04-2012                    | Revision # | Revision version |
| Revision | First bill of materials (BOM) |            |                  |

